



Multi-level Wooden Dollhouse

Assembly Instructions



ITEM #4570

© 2007 Melissa & Doug LLC
All rights Reserved
www.MelissaAndDoug.com

We care about your comments.
Please call us! 1-800-284-3948

Multi-level Wooden Dollhouse

PARTS

Page 1 of 2

(one of each part except where noted)

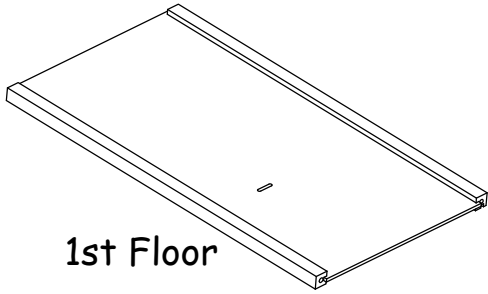

1st Floor

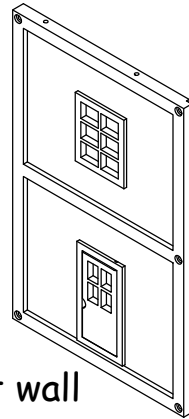

Left wall

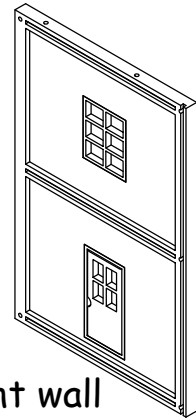

Right wall

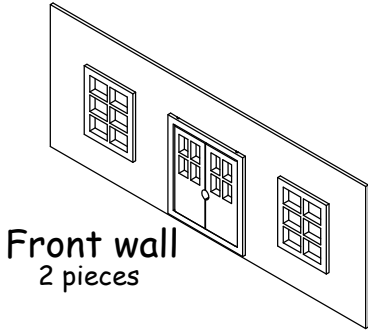

Front wall
2 pieces

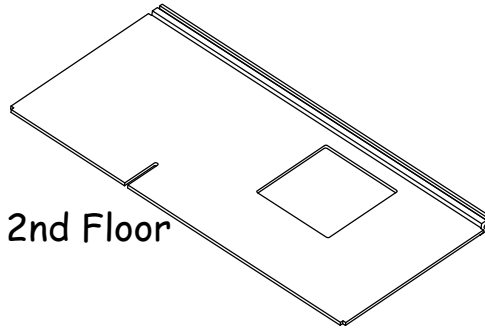

2nd Floor

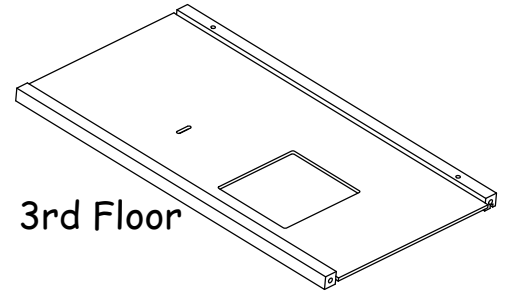

3rd Floor

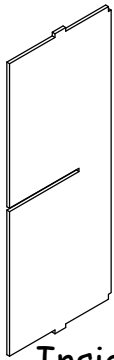

Inside wall

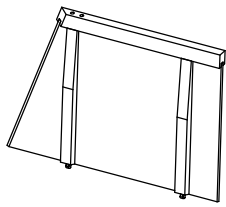

Left roof

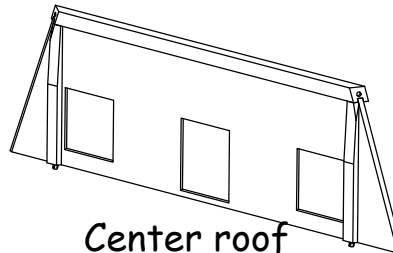

Center roof

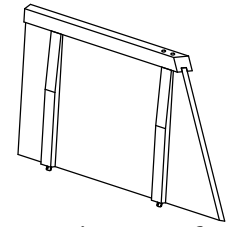

Right roof



3rd floor
roof window
2 pieces



3rd floor
roof door

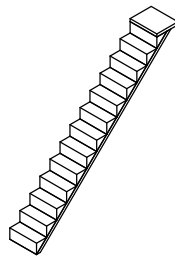

Staircase
2 pieces

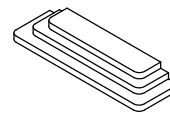

Front steps

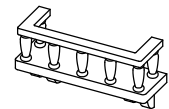

Balcony
2 pieces



Wood screw
3 pieces

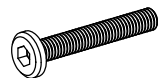

Hex head bolt
10 pieces

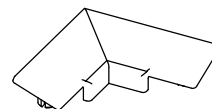

Roof connector
2 pieces

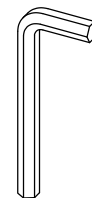

Hex key

Please note that some screws may be supplied with extra parts

Multi-level Wooden Dollhouse

PARTS

Page 2 of 2

(one of each part except where noted)

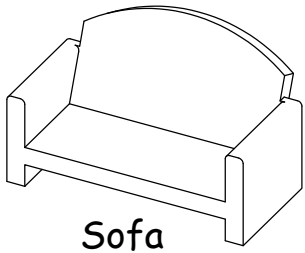

Sofa

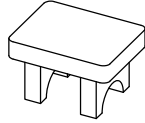

Ottoman

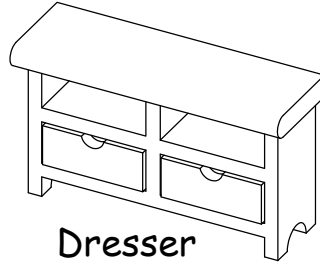

Dresser

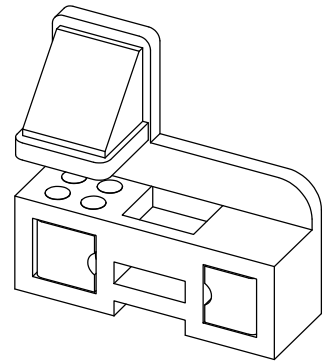

Kitchen Counter

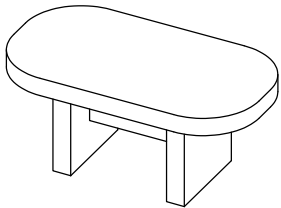

Dining Table

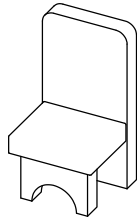

Dining Chair
4 pieces

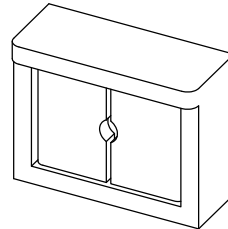

Cabinet

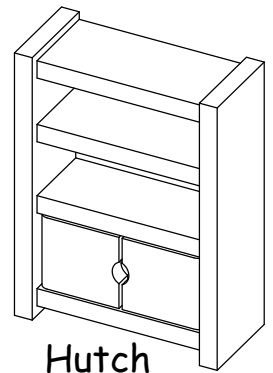

Hutch

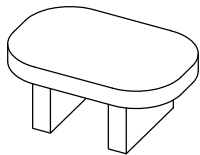

Coffee Table

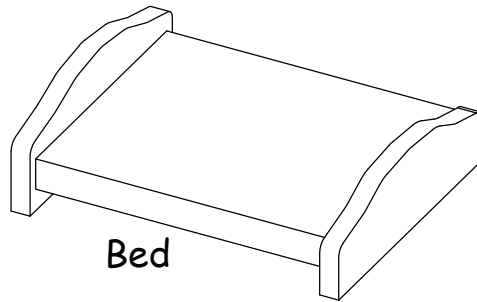

Bed

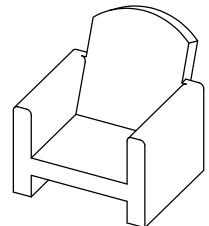

Easy Chair
2 pieces

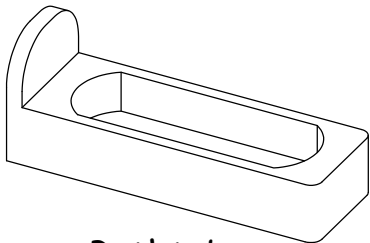

Bathtub

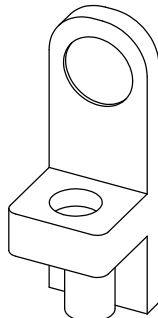

Bathroom Sink

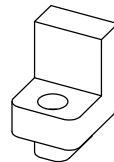

Toilet

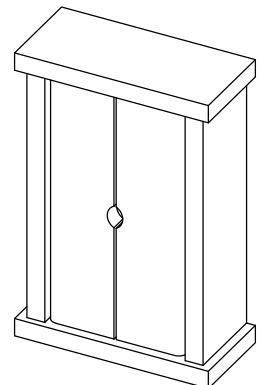

Armoire

Multi-level Wooden Dollhouse

STEP 1

Assemble Left and Right walls to the 1st Floor using 4 Hex Bolts as shown.

Do not tighten the bolts completely at this time.

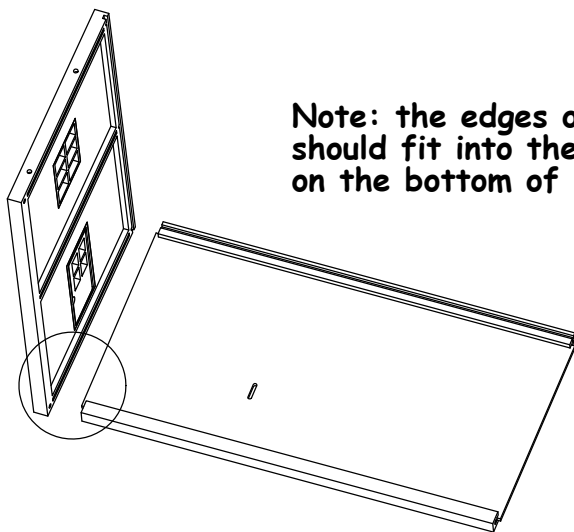
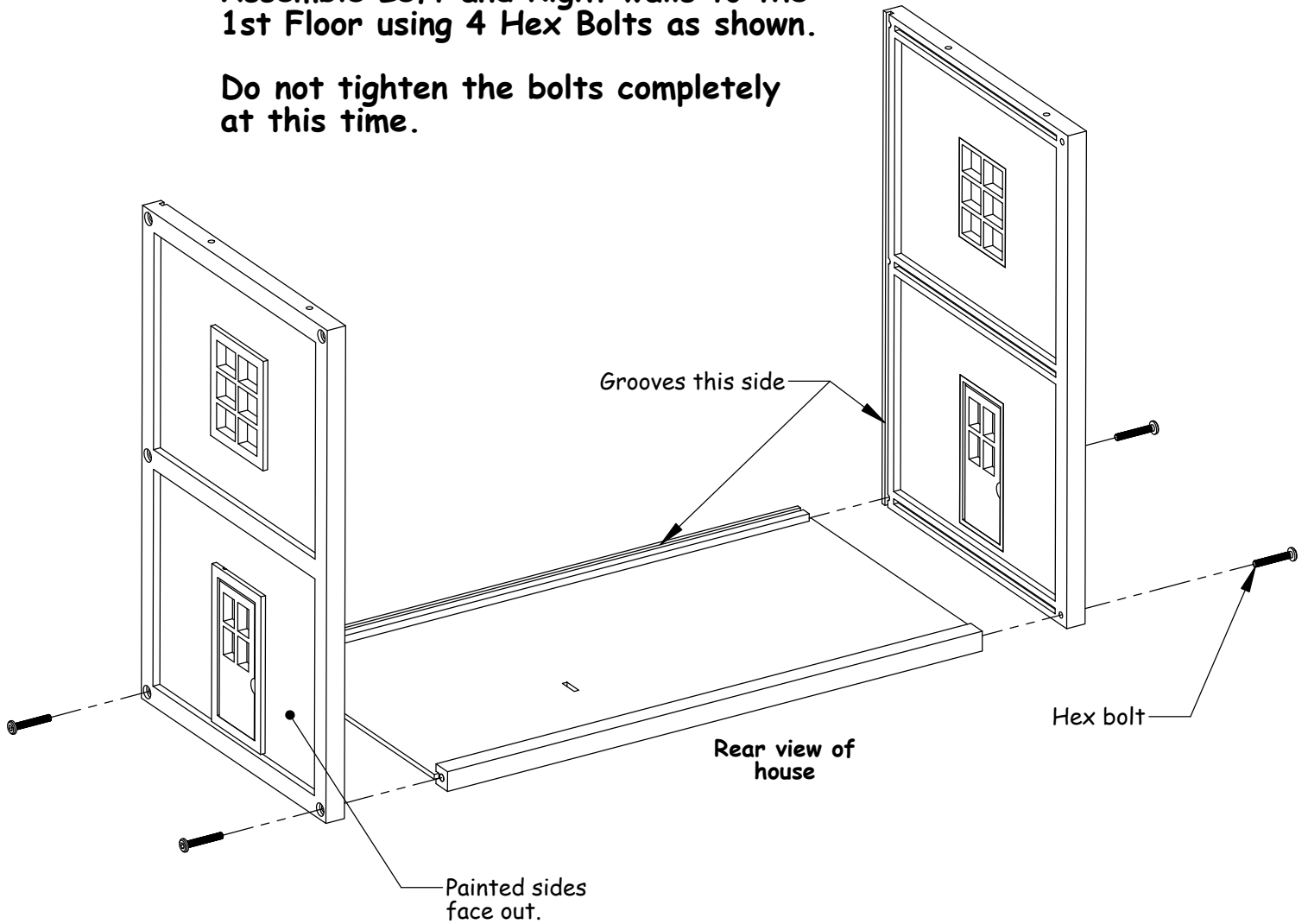

Note: the edges of the floor should fit into the grooves on the bottom of both walls.

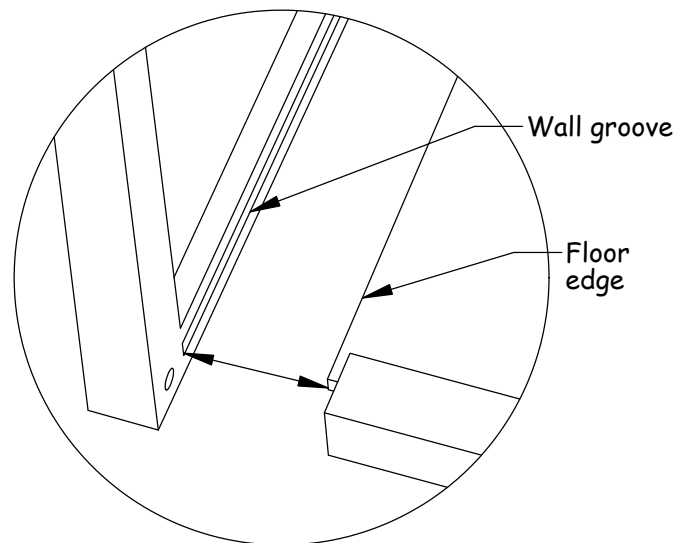

Check when done

Multi-level Wooden Dollhouse

STEP 2

Insert one of the front walls between the side walls as shown, making sure that it fits into the grooves on the left and right side walls, and into the bottom floor.

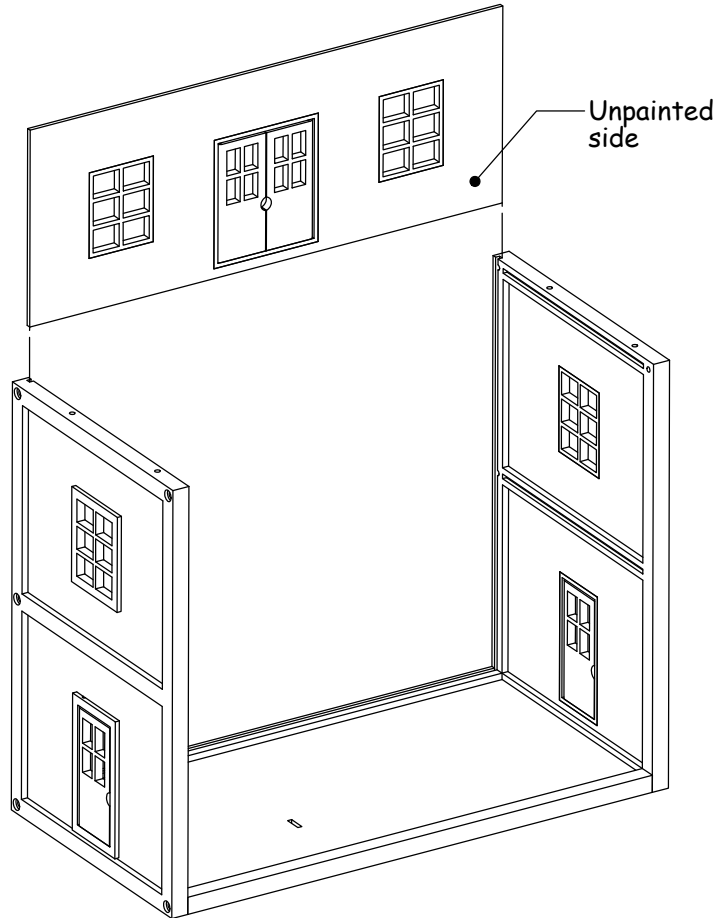

STEP 3

Now fit the 2nd floor into the grooves in the side walls and onto the top edge of the front wall as shown here.

Insert 2 Hex Bolts as shown, but do not tighten completely yet.

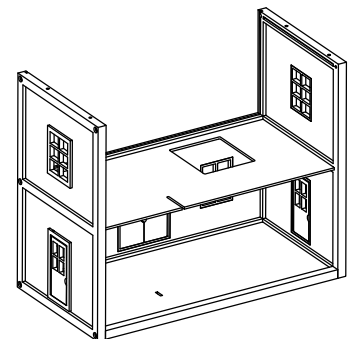
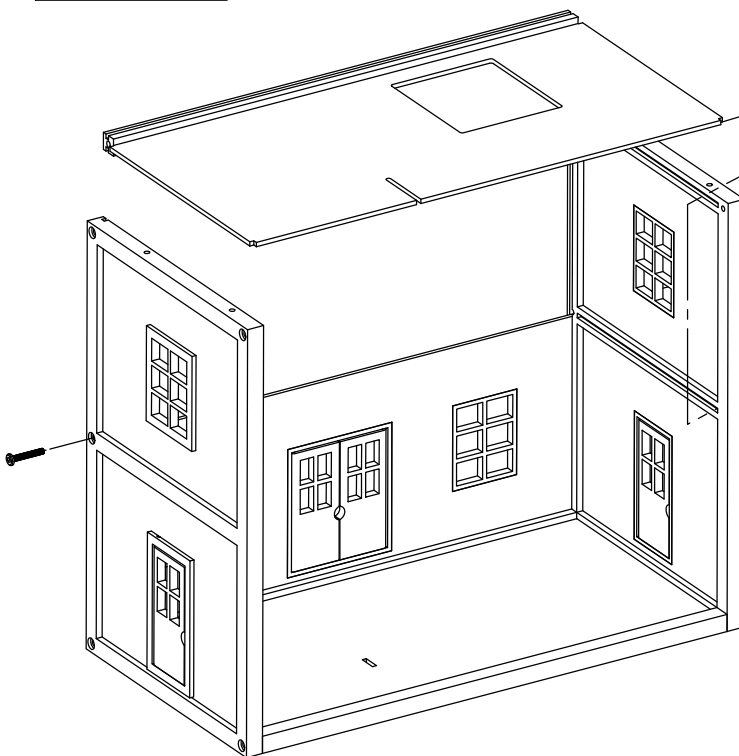

Assembled View

Check when done



Multi-level Wooden Dollhouse

STEP 4

Attach the inner wall panel by sliding it into the slot in the 2nd Floor as shown.

Make sure that the slot in the wall faces the slot in the floor.

Also check that the bottom tab on the wall fits into the slot in the floor.

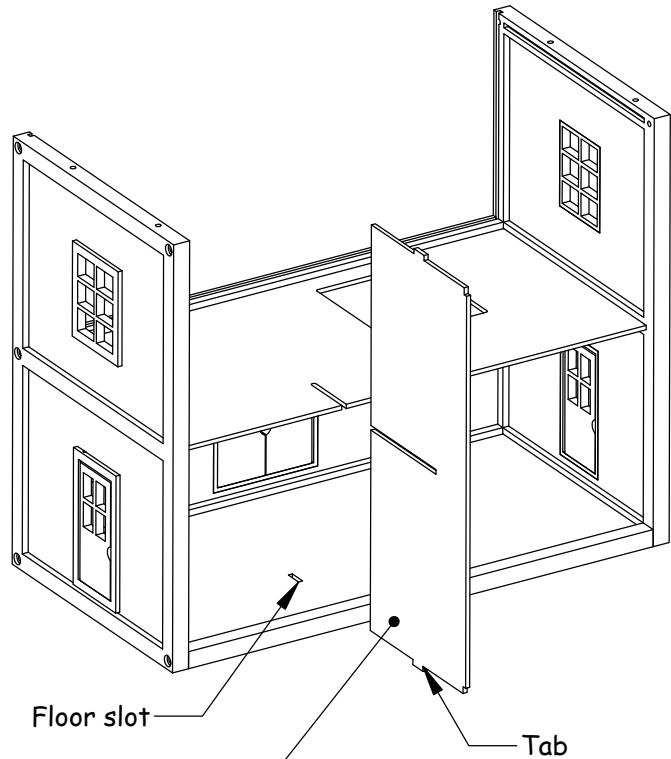

Note: This wall can be installed either right side up or upside down. Either way is ok.

STEP 5

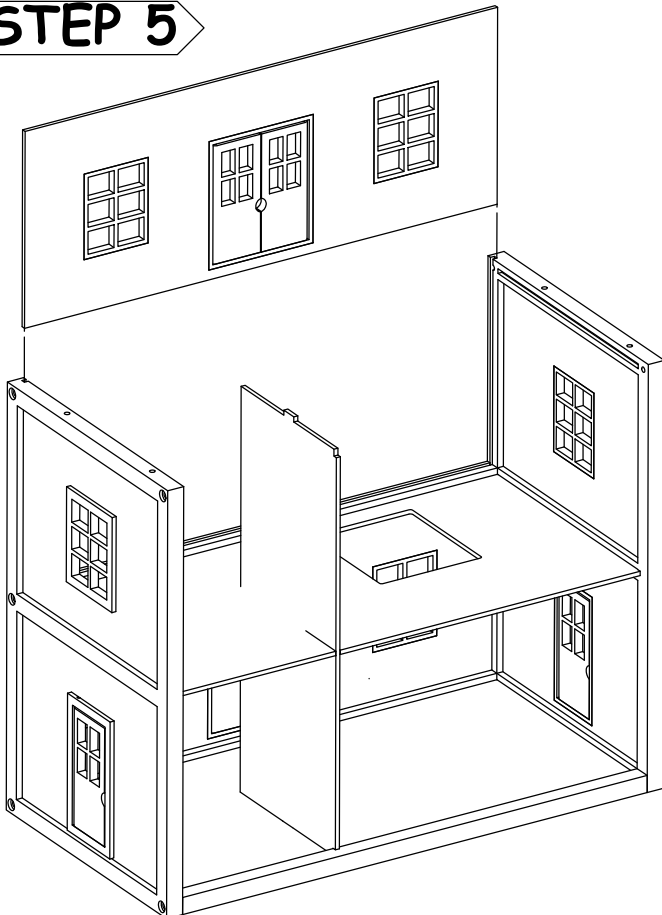

Slide the remaining Front Wall into the grooves of the left and right walls as shown making sure that the wall also fits into the groove at the front of the 2nd floor.

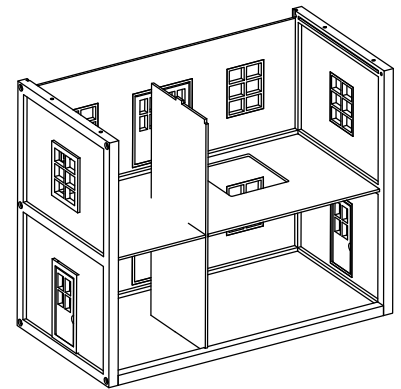

Assembled View

Check when done

Multi-level Wooden Dollhouse

STEP 6

Fit the 3rd Floor as shown inserting the ends into the grooves of the side walls.

Using 4 Hex Bolts, secure the 3rd floor and tighten.

You can now go back to all 10 of the Hex Bolts and finish tightening completely.

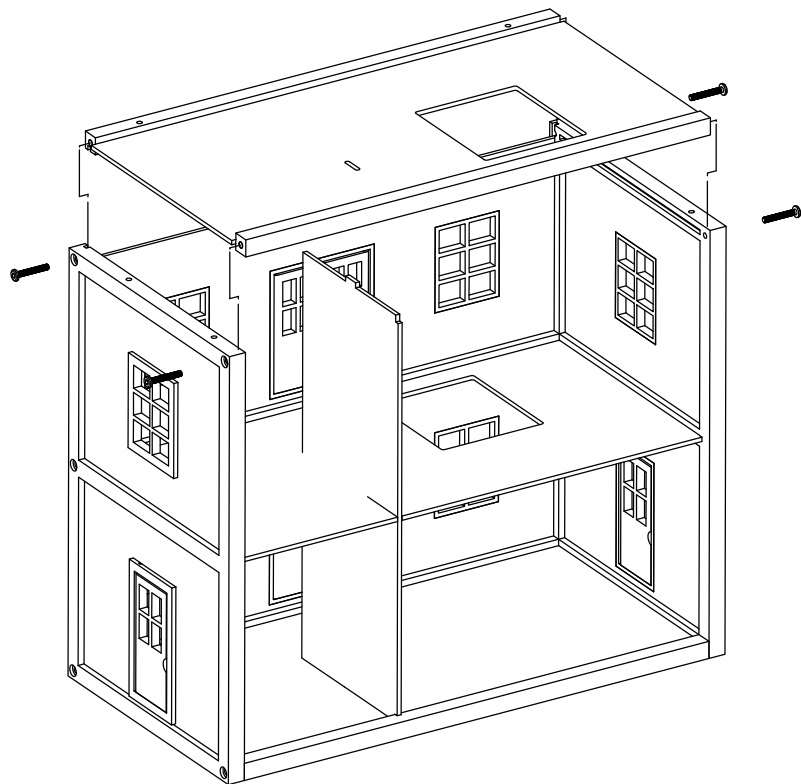

STEP 7

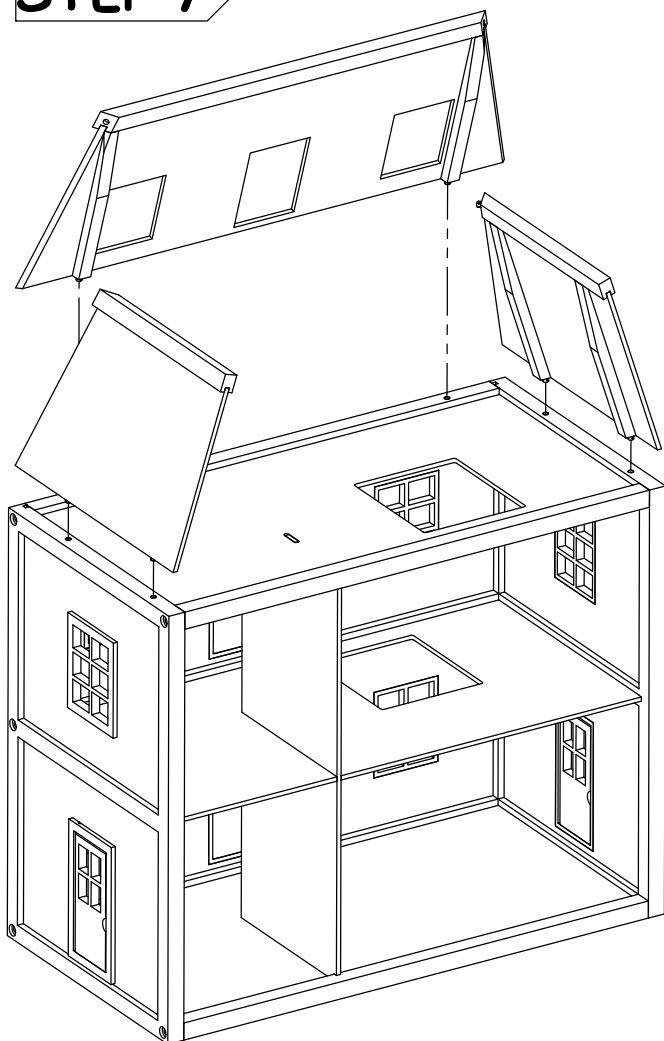

Attach the Left, Right and Center Roof panels as shown by pushing the pegs on the bottom of the parts into the holes on top of the house.

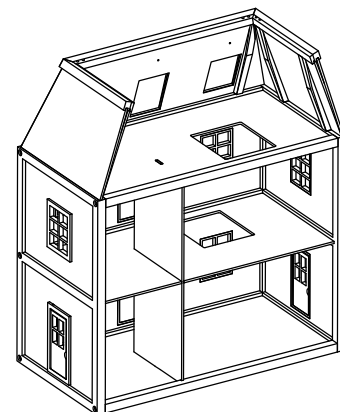

Assembled View

Check when done



Multi-level Wooden Dollhouse

STEP 8

Press in 2 Roof Connectors at the top corners of the roof.

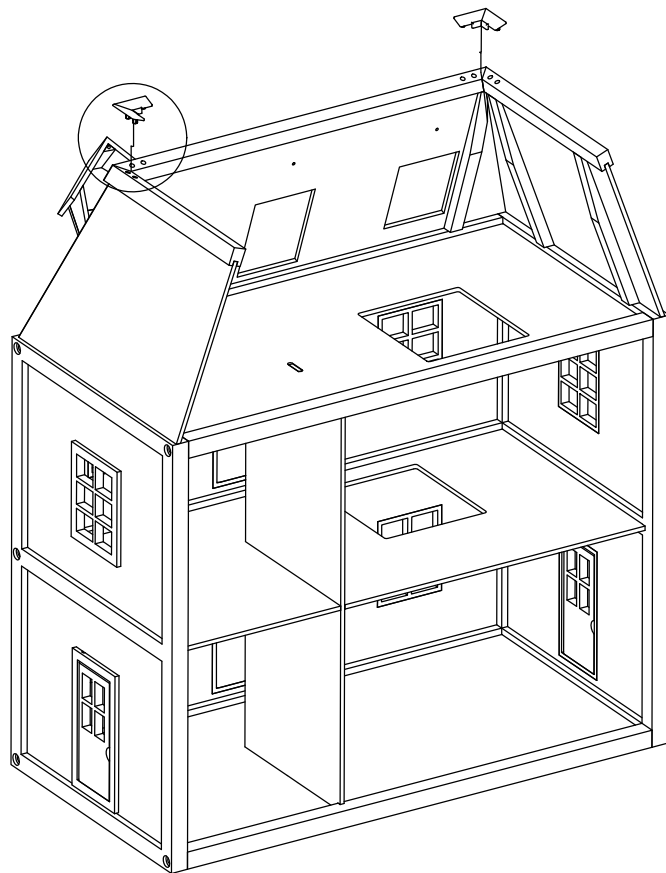
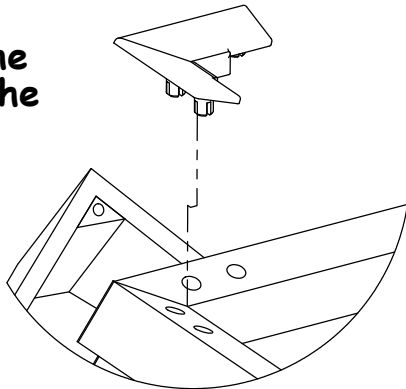

STEP 9

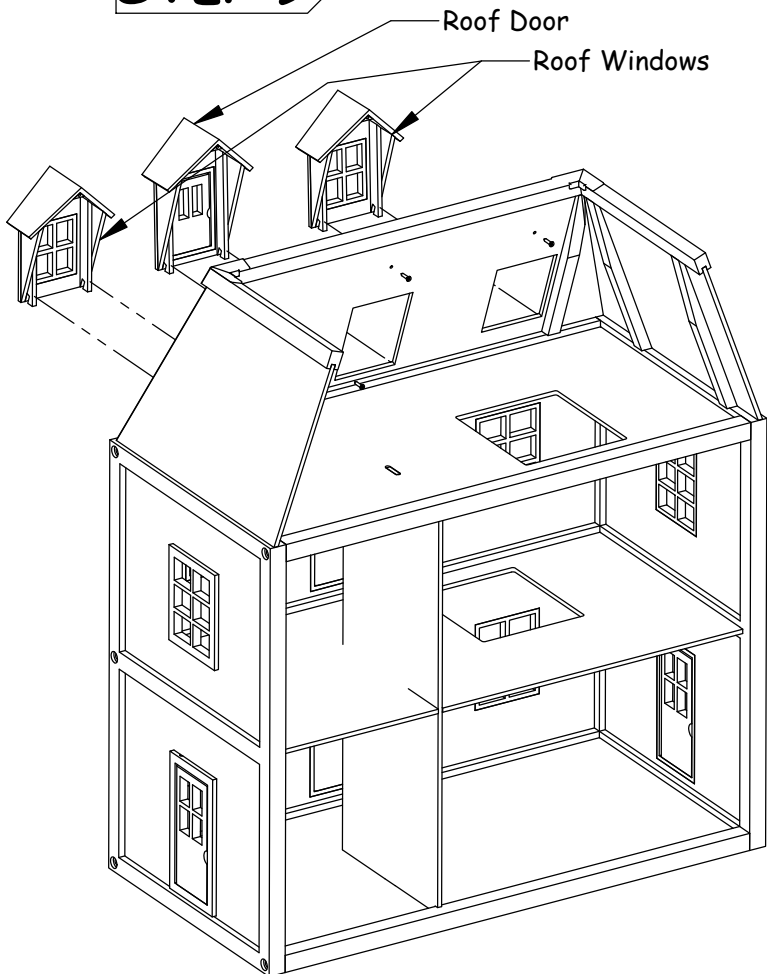

Using 3 Wood Screws, attach the Roof Door and 2 Roof Windows by fitting the notches at the bottom of the part over the opening in the roof as shown below, then tightening the screws.

Be sure to attach the Roof Door in the center opening of the roof.

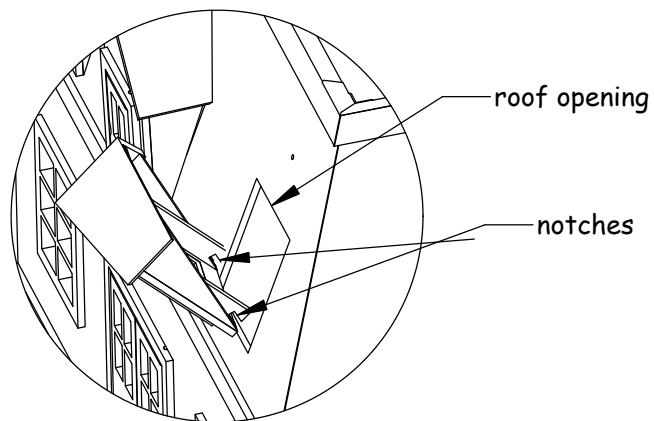

Check when done



Multi-level Wooden Dollhouse

STEP 10

Attach 2 Balconies and the Front Steps by plugging in the pegs on the parts to the holes in the front of the house as shown.

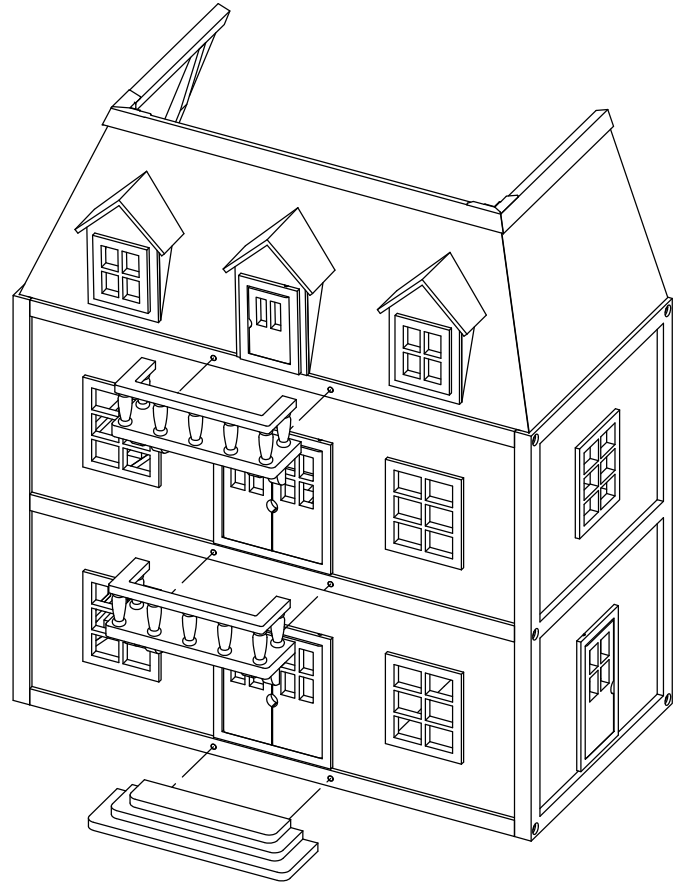

STEP 11

The Staircases for the 2nd and 3rd floor are shown here in a recommended position, but you can place them to either side as you decorate your Dollhouse with the included furniture.

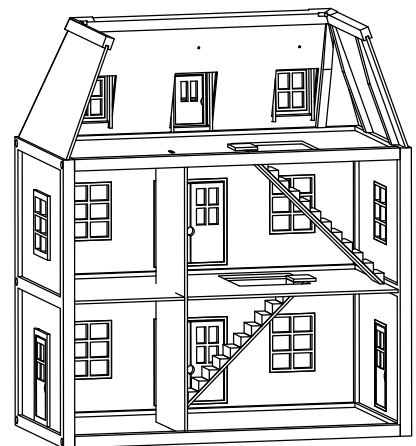
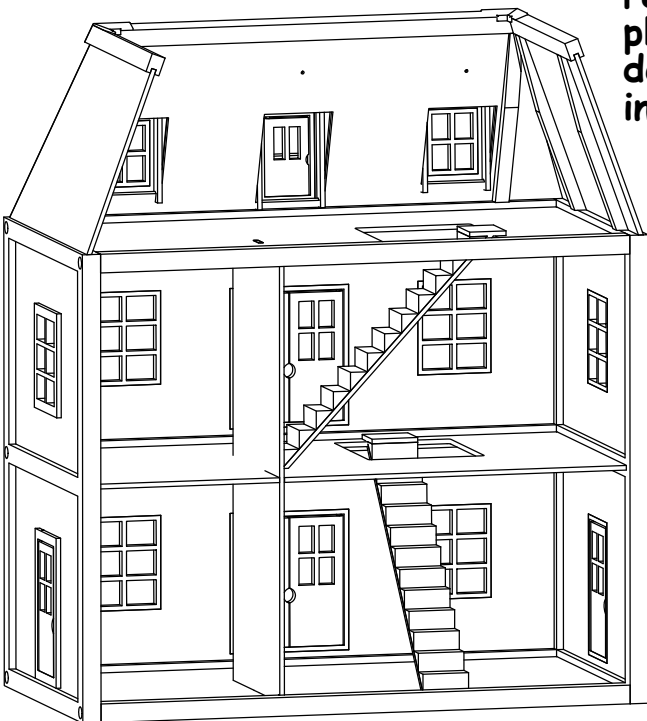

Check when done

